

# Customer Service and Support

## ONLINE SERVICES

support.wdc.com  
www.westerndigital.com

## TECHNICAL SUPPORT BY PHONE

### Asia Pacific

Australia	+800 6008 6008
China	800 820 6682
Hong Kong	+800 6008 6008
India	000 800 4401043
Indonesia	001 803 852 9439
Malaysia	+800 6008 6008 / 1800 88 1908
Philippines	+1800 1441 0159
Singapore	+800 6008 6008 / 1800 608 6008
Taiwan	+800 6008 6008

**EMEA** +31 20 4467651

**Latin America** 949.672.7000  
Spanish 949.672.7199

**North America** 800.ASK.4WDC

If you need additional information or help during installation of WD products, our support Web site offers state-of-the-art online services that include a comprehensive knowledge base, standard and advance RMA service, and free online diagnostic and utility software. When calling for support, you must provide your WD hard drive serial number along with your system hardware and software versions for our customer service staff to assist you.

Western Digital, WD Caviar, and WD Raptor are registered trademarks; and WD, the WD logo, NetCenter, WD Dual-option, WD Essential, WD Extreme, WD Passport, WD Scorpio, Data Lifeguard, Data Lifeguard Tools, DuraStep Ramp, EasyLink, FlexPower, RAFF, Safe Shutdown, SecureConnect, Shock Guard, ShockShield, SoftSeek, and WhisperDrive are trademarks of Western Digital Technologies, Inc. Other trademarks may be mentioned herein that belong to other companies. Data reflects product in production as of August 2005. Not all products may be available in all regions of the world. Product specifications are subject to change without notice.

© 2005 Western Digital Technologies, Inc. All rights reserved.



### Corporate Headquarters

Western Digital  
20511 Lake Forest Drive  
Lake Forest, California 92630 U.S.A.

2278-001000-A04 8/05

# Product Guide FALL 2005

Desktop Drives  
Enterprise Drives  
Mobile Drives  
External Products  
2.5-inch EIDE Drives  
Dual-option backup  
Serial ATA Drives  
WD Extreme Drives  
Desktop SATA Hard Drives  
Portable Drives  
Network Storage



WD Hard Drives

# Product Guide **FALL 2005**



## The WD Promise

WD understands the importance of the information you save to your hard drive and we are committed to protecting that data with exceptionally reliable products, advanced data protection technology, and superior customer support. No one does more to safeguard your data than WD.

PUT YOUR LIFE ON IT.™

## Table of Contents

Company Overview	3-6
Data Lifeguard™ Data Protection	7-8
Hard Drives for Every Market	9-10
Enterprise Hard Drives	11-12
Desktop Hard Drives	13-14
Mobile Hard Drives	15-16
Hard Drive Kits	17-20
External Hard Drives	21-28
Accessories	29
Awards	30
Contact Information	31

## Company Overview

As one of the data storage industry's pioneers and longtime leaders, WD provides cost-effective storage products for people and organizations that collect, manage, and use digital information. The company's customers use reliable WD hard drives and external storage products for business, home, mobile, and entertainment applications to keep their data close-at-hand and secure from loss.

## Customer Service and Support

Our commitment to quality and service is uncompromising. We continually strive to maximize customer satisfaction by providing world-class technical support through telephone and online services. State-of-the-art services include:

- Extensive online knowledge base.
- Technical representatives available through both e-mail and localized telephone support.
- Comprehensive technical information ranging from product specifications to diagnostic codes.
- Drivers, installation, and diagnostic software available online.
- Wide-ranging warranty services, including standard and advance product replacement.



## The Hard Drive Inside

For more than seventeen years, award-winning WD hard drives have helped people collect, manage, and use digital information. We make the hard drives found in millions of PCs bearing the labels of the world's leading PC producers. You'll find our drives in a host of servers that provide massive storage for businesses and online services. We also make the drives in notebook computers, gaming consoles, personal video recorders, set-top boxes, and other popular consumer electronics products.

PC, server, and consumer electronics manufacturers, our biggest customers and our toughest critics, insist on the highest standards of quality, reliability, and customer service. Because we unflinchingly meet those standards, we have become the second largest drive manufacturer in the world.

We know a lot about the need for reliable and responsive information storage, both at home and on the job. So we are building our hard drives bigger and faster, and equipping them with features to make them ever more reliable and user-friendly.



## Unique Features for SATA Hard Drives

- SecureConnect™ – provides a 500 percent stronger cable-to-drive connection than first-generation SATA hard drives and cables; ensures backward compatibility with legacy SATA cables and backplanes.
- FlexPower™ – connector technology that accepts power from both industry-standard and new SATA power supplies.

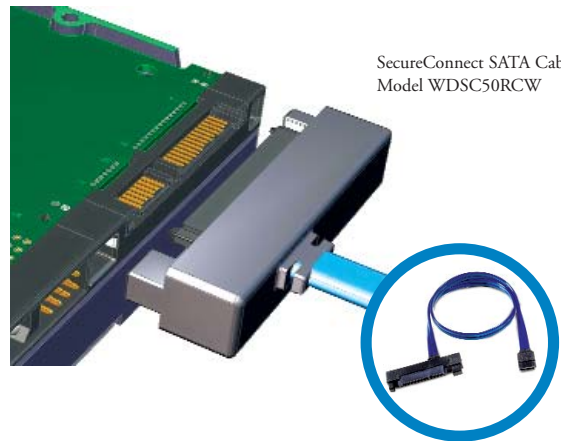

SecureConnect SATA Cable  
Model WDSC50RCW

## Data Lifeguard

### WD's Commitment to Quality and Data Integrity

WD understands the importance of the data stored on our hard drives. We are committed to providing our customers with reliable, high-performance storage products and superior customer service. The WD commitment is carried out in features such as our exclusive Data Lifeguard hardware components, software utilities, and services that provide the highest level of data protection available on hard drives today.



## Data Lifeguard Protection

### Environmental

**Shock Guard™** prevents damage to internal components of the drive during shipping and handling and in daily operation. Shock Guard allows instantaneous data protection at high shock values to achieve operating shock specifications as high as 300 Gs.

**ShockShield™** provides double protection from rough handling and static damage. Wrapped in a static protection envelope and securely packed in a plastic case, this protective pack provides 30 percent more protection from shock damage than Seagate's SeaShell pack.

**Environmental Protection Filters** help protect the inside of the hard drive from damaging humidity, extreme temperature, and contamination.

**Protective Head Parking** adds another layer of protection to auto-park by safely parking the heads even if other system components lose functionality.

### Data Integrity

**Embedded Error Detection and Repair** features automatically find, isolate, and repair problem areas that may develop over the extended use of the hard drive.

**Error Correction Code (ECC)** performs on the fly to detect and correct errors as data is read and written.

**Rotary Acceleration Feed Forward (RAFF™)** optimizes operation and performance when drives are used in vibration-prone, multi-drive systems such as rack-mounted servers. *(Available on most enterprise-class WD drives.)*

**Time-Limited Error Recovery (TLER)** improves compatibility with RAID adapters; prevents drive fallout caused by the extended hard drive error-recovery processes common to desktop hard drives.

*(Available on most enterprise-class WD drives.)*

**DuraStep Ramp™** technology locks the heads off the data disk to provide additional shock protection. Using the most technologically advanced material available, the drive is able to perform a minimum of 600,000 cycles without contamination – up to twice the performance of its competitors. *(Available only on WD's mobile hard drives.)*

### Installation and Diagnostics

**Data Lifeguard Tools™** software utilities easily partition and format new hard drives, overcome operating system and BIOS limitations, quickly and safely copy the contents of an existing hard drive onto a new hard drive, and can diagnose and repair many drive problems that may arise. Ships with retail-packaged drives and is available online.

**S.M.A.R.T.** monitors hard drive operation to predict errors before data loss can occur.

**Online Diagnostic Service** provides an easy method to physically test the health of a hard drive installed in a system without the need to create a bootable diskette or reboot the system.



# Hard Drives for EVERY MARKET



## WD offers HIGH-QUALITY HARD DRIVES for every market segment.

Product Type	Product Name	Desktop	Enthusiast	Enterprise	Consumer Electronics	Notebook	Portable
INTERNAL	3.5-inch, 10,000 RPM		■	■			
	3.5-inch, 7200 RPM	WD Raptor®		■	■		
		WD Caviar® RE2			■		
		WD Caviar RE			■		
		WD Caviar SE16	■	■		■	
WD Caviar SE	■			■			
WD Caviar	■			■			
2.5-inch, 5400 RPM	WD Scorpio™					■	
EXTERNAL	Desktop	■					
	Portable	■	■			■	■
		WD Dual-option™	■				
	WD Essential™	■					
	WD Extreme™	■	■				
	WD Passport™	■				■	



# Enterprise Drives

## High Performance, High Reliability

### WD Raptor



Built for speed! WD Raptor 10,000 RPM hard drives with state-of-the-art vibration tolerance are a unique class of drives that matches SCSI reliability and performance while providing simplified connectivity – all at lower cost than Parallel SCSI drives. WD Raptor maintains high standards and lowers the cost of enterprise data storage.

**Ideal for:** High-speed servers, network-attached storage, and workstations.



## High Capacity, High Reliability

### WD Caviar RE2



With 1.2 million hours MTBF, a 5-year warranty, next-generation SATA technology, state-of-the-art vibration tolerance, and time-limited error recovery (TLER), these 7200 RPM drives offer the best combination of reliability, high capacity, and performance for RAID server applications.

**Ideal for:** Servers and network-attached storage.

### WD Caviar RE



WD Caviar RE drives are based on the highly reliable WD Caviar platform and offer enterprise-specific features that make them exceptionally reliable for high-capacity nearline storage applications.

**Ideal for:** Servers and network-attached storage.

## Enterprise Hard Drives

Product	Interface	Transfer Rate	Spin Speed	Cache	Queuing	MTBF	Average Read Seek	Warranty	Capacity	Model Number
WD Raptor	SATA	1.5 Gb/s	10,000 RPM	8 MB	TCQ*	1.2 million hours	4.5 ms	5 years	74 GB 36 GB	WD740GD WD360GD
WD Caviar RE2	SATA	1.5 Gb/s	7200 RPM	16 MB	NCQ	1.2 million hours	8.7 ms	5 years	400 GB	WD4000YR
WD Caviar RE	SATA	1.5 Gb/s	7200 RPM	8 MB	n/a	1 million hours	8.9 ms	5 years	320 GB	WD3200SD
									250 GB	WD2500YD
									160 GB	WD1600YD
	EIDE	100 MB/s	7200 RPM	8 MB	n/a	1 million hours	8.9 ms	5 years	320 GB	WD3200SB
									250 GB	WD2500SB
									160 GB	WD1600SB
									120 GB	WD1200SB

\* Field configurable

# Desktop Drives

## Highest Performance

### WD Caviar SE16



These exceptionally fast, quiet, and cool drives combine 16 MB cache for state-of-the-art performance with up to 400 GB of storage to deliver a perfect solution for the fully-loaded PC with an ultra-fast processor.

**Ideal for:** Graphic design, video editing, gaming, and advanced business computing.

## High Performance

### WD Caviar SE



Cool-running, quiet operation, superior performance, and industry-leading reliability make these drives the perfect hard drives for desktop, business, and consumer electronics storage.

**Ideal for:** High performance family computing such as photo editing and multimedia functions as well as small to medium business computing.

## Mainstream

### WD Caviar



With performance geared to mainstream desktop personal computers, WD Caviar drives are built to the highest standards of quality and reliability.

**Ideal for:** E-mail, web browsing, music, home office, and small business computing.

## Desktop SATA and EIDE Drives

Product	Interface	Transfer Rate	Spin Speed	Cache	Average Read Seek	Warranty	Capacity and Model Number
WD Caviar SE16	SATA	150 MB/s	7200 RPM	16 MB	8.7 ms	3 years	400 GB — WD4000KD
	SATA	300 MB/s	7200 RPM	16 MB	8.9 ms	3 years	250 GB — WD2500KS
WD Caviar SE	SATA	300 MB/s	7200 RPM	8 MB	8.9 ms	3 years	250 GB — WD2500JS
							160 GB — WD1600JS
	SATA	150 MB/s	7200 RPM	8 MB	8.9 ms	3 years	320 GB — WD3200JD
							250 GB — WD2500JD
EIDE	100 MB/s	7200 RPM	8 MB	8.9 ms	3 years	160 GB — WD1600JD	
						80 GB — WD800JD	
WD Caviar	SATA	150 MB/s	7200 RPM	2 MB	8.9 ms	3 years	300 GB — WD3000JB
							200 GB — WD2000JB
	EIDE	100 MB/s	7200 RPM	2 MB	8.9 ms	3 years	160 GB — WD1600JB
							80 GB — WD800JB
SATA	150 MB/s	7200 RPM	2 MB	8.9 ms	3 years	80 GB — WD800BD	
						250 GB — WD2500BB	
EIDE	100 MB/s	7200 RPM	2 MB	8.9 ms	3 years	160 GB — WD1600BB	
						80 GB — WD800BB	



# Mobile Drives

## 5400 RPM 2.5-inch EIDE Drives

WD Scorpio offers leading-edge performance with power requirements comparable to much slower drives.

**Advantages:**

**Fast**

Spins at 5400 RPM and delivers seek times of 12 ms. Available with 2 or 8 MB cache.

**Quiet**

Features WD's exclusive WhisperDrive™ technology with SoftSeek™ algorithms to deliver the quietest-seeking 2.5-inch hard drive on the market.

**Reliable**

Shock Guard protects the drive from shocks up to 250 Gs while in operation and 900 Gs when idle.

DuraStep Ramp technology locks the heads of the data disk to provide additional shock protection. Using the most technologically advanced material available, the drive is able to perform a minimum of 600,000 cycles without contamination – up to twice the performance of its competitors.

**Rugged**

WD Scorpio's rigid top cover withstands greater than five pounds of pressure – nearly 1.5 times the industry average – without pinching the motor hub or other internal components.

**Ideal for:** Portable digital devices of all kinds including notebook computers, external storage, digital audio to GPS systems, car navigation, blade servers, and tablet PCs.

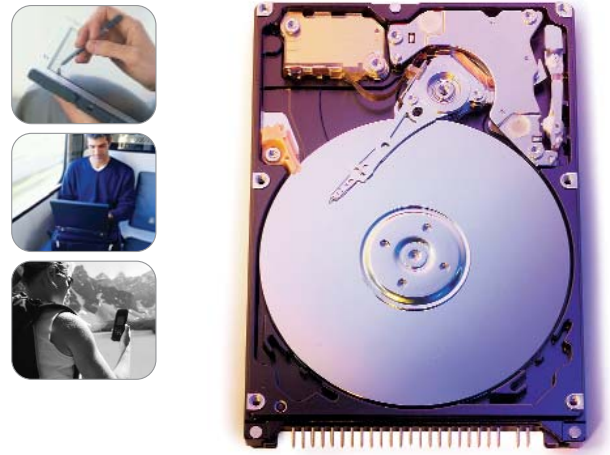

### Mobile Hard Drives

Product	Interface	Transfer Rate	Spin Speed	Cache	Average Read Seek	Warranty	Capacity	Model Number
WD Scorpio (8 MB cache)	EIDE	100 MB/s	5400 RPM	8 MB	12.0 ms	3 years	80 GB	WD800VE
							60 GB	WD600VE
							40 GB	WD400VE
WD Scorpio (2 MB cache)	EIDE	100 MB/s	5400 RPM	2 MB	12.0 ms	3 years	80 GB	WD800UE
							60 GB	WD600UE
							40 GB	WD400UE

# Hard Drive Kits

WD's internal hard drives are available in retail kits that include hardware, software, and step-by-step illustrated instructions for quick and easy installation.



## 10,000 RPM SATA 150 MB/s

Model Number	Capacity	Interface	Transfer Rate	Spin Speed	Cache	Average Read Seek	Warranty
WD740GDRTL	74 GB	SATA	150 MB/s	10,000 RPM	8 MB	4.5 ms	5 years
WD360GDRTL	36 GB	SATA	150 MB/s	10,000 RPM	8 MB	4.5 ms	5 years

Complete kit includes: SATA hard drive, SecureConnect SATA cable, Quick Install Guide, and mounting screws.



## 7200 RPM SATA 300 MB/s

Model Number	Capacity	Interface	Transfer Rate	Spin Speed	Cache	Average Read Seek	Warranty*
WD2500KSRTL	250 GB	SATA	300 MB/s	7200 RPM	16 MB	8.9 ms	1 year

Complete kit includes: SATA hard drive, SecureConnect SATA cable, installation and drive management software CD, Quick Install Guide, and mounting screws.



## 7200 RPM SATA 150 MB/s

Model Number	Capacity	Interface	Transfer Rate	Spin Speed	Cache	Average Read Seek	Warranty*
WD4000KDRTL	400 GB	SATA	150 MB/s	7200 RPM	16 MB	8.7 ms	1 year
WD3000JDRTL	300 GB	SATA	150 MB/s	7200 RPM	8 MB	8.9 ms	1 year
WD2500JDRTL	250 GB	SATA	150 MB/s	7200 RPM	8 MB	8.9 ms	1 year
WD2000JDRTL	200 GB	SATA	150 MB/s	7200 RPM	8 MB	8.9 ms	1 year
WD1600JDRTL	160 GB	SATA	150 MB/s	7200 RPM	8 MB	8.9 ms	1 year
WD1200JDRTL	120 GB	SATA	150 MB/s	7200 RPM	8 MB	8.9 ms	1 year
WD800JDRTL	80 GB	SATA	150 MB/s	7200 RPM	8 MB	8.9 ms	1 year

Complete kit includes: SATA hard drive, SecureConnect SATA cable, installation and drive management software CD, Quick Install Guide, and mounting screws.





### 7200 RPM 3.5-inch EIDE

Model Number	Capacity	Interface	Transfer Rate	Spin Speed	Cache	Average Read Seek	Warranty*
WD3200JBRTL	320 GB	EIDE	100 MB/s	7200 RPM	8 MB	8.9 ms	1 year
WD3000JBRTL	300 GB	EIDE	100 MB/s	7200 RPM	8 MB	8.9 ms	1 year
WD2500JBRTL	250 GB	EIDE	100 MB/s	7200 RPM	8 MB	8.9 ms	1 year
WD2000JBRTL	200 GB	EIDE	100 MB/s	7200 RPM	8 MB	8.9 ms	1 year
WD1600JBRTL	160 GB	EIDE	100 MB/s	7200 RPM	8 MB	8.9 ms	1 year
WD1200JBRTL	120 GB	EIDE	100 MB/s	7200 RPM	8 MB	8.9 ms	1 year
WD800JBRTL	80 GB	EIDE	100 MB/s	7200 RPM	8 MB	8.9 ms	1 year

Complete kit includes: EIDE hard drive, jumper shunt 40-pin 80-conductor EIDE interface cable, installation and drive management software CD, Quick Install Guide, and mounting screws.



### 5400 RPM 2.5-inch EIDE

Model Number	Capacity	Interface	Transfer Rate	Spin Speed	Cache	Average Read Seek	Warranty*
WD800VERTL	80 GB	EIDE	100 MB/s	5400 RPM	8 MB	12.0 ms	1 year
WD600VERTL	60 GB	EIDE	100 MB/s	5400 RPM	8 MB	12.0 ms	1 year
WD400VERTL	40 GB	EIDE	100 MB/s	5400 RPM	8 MB	12.0 ms	1 year

Complete kit includes only the EIDE hard drive. Professional installation recommended.



\*One-year standard warranty unless otherwise required by law.

# External Products

## WD Dual-option Drives



WD offers a full line of external storage products that give you the choice of two backup options – automatic or on-demand. Set it and forget it, or back up your files only when you want. A button glows blue to let you know your data will be backed up automatically. The convenient, front-mounted power button includes Safe Shutdown™ technology to ensure that all data is safely transferred before shutting down the drive. Compatible with both Windows® and Macintosh® systems.

## Combo Drives

Dual-option backup, an elegant, stackable case, and a USB 2.0 hub combine to make WD Dual-option Combo USB 2.0/FireWire drives the ideal solution for that much-needed additional storage and a perfect place to back up valuable data, music, photos, and movies.



## Media Center

This full-featured storage Media Center combines a USB 2.0/FireWire® external hard drive, 8-in-1 memory card reader, and USB 2.0 hub for versatility and space-saving convenience.



## USB Drives

WD Dual-option external USB 2.0 hard drives are preformatted and ready to back up valuable data, music, photos, and movies, and are terrific for digital video editing and MP3 downloads.



# WD Essential Drives

## NetCenter™ Network Drives

Essential for your network.

It's Easy! In just three simple steps you can add shared storage to your home or office wired or wireless network.

1. Plug in the drive.
2. Run the wizard.
3. Use WD's EasyLink™ utility to set up NetCenter as a local drive on any computer on the network.



With NetCenter you can:

- Centralize and share data in your home or office.
- Connect a printer and share it with any computer on the network.
- Create private, password-protected folders.
- Back up files from any computer on the network.
- Connect with both PC and Macintosh computers.
- Access files any time, from any computer on your network, even when all other computers are off.
- Connect another external drive to add even more storage.



## USB Drives

Just the essentials – add high-speed, easy-to-use, reliable storage. Simply plug it in and you've got plenty of room to back up and save your valuable data, music, photos, and movies.

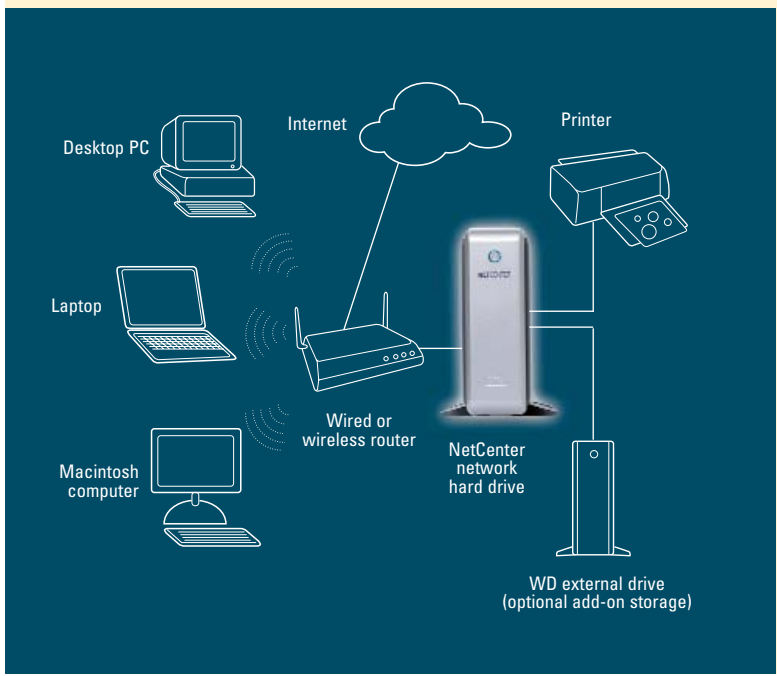



## WD Passport Drives

### Portable Hard Drives

Rugged, highly portable WD Passport drives let you add storage instantly for all your business files, music, video, and games, back up your existing notebook hard drive for extra data safety, and easily share files between computers.



Actual Size

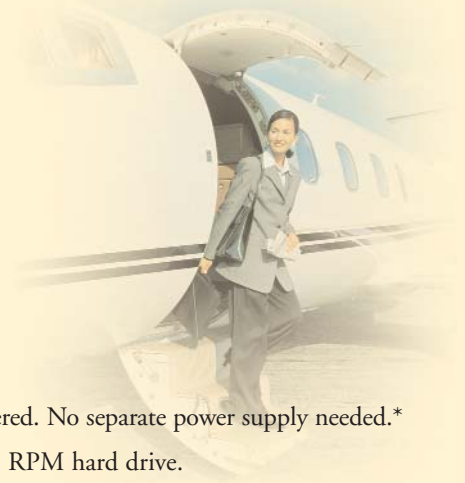

### Features:

- USB powered. No separate power supply needed.\*
- Fast, 5400 RPM hard drive.
- Maximum protection from data loss with a rugged, protective case and shock-tolerant 2.5-inch hard drive.
- Power-conserving design prolongs laptop battery life.
- Ultra quiet. Cool running.
- Elegant, soft-touch case provides easy handling.
- Safety tested. One of the few external drives with certification to meet all applicable safety requirements.



\* An optional power adapter is available for the few laptops that limit bus power.



# WD Extreme Drives

## Lighted Combo Drives

Case modders, gamers, DJs, and anyone with a love of the extreme will appreciate this jazzy light-up external hard drive with customizable color settings. Pick your favorite color on this glow-in-the-dark external drive or switch to kaleidoscope mode for eye-catching fun. High capacity, lightning fast performance, and WD's legendary quality make this a serious storage device too. With capacities up to 320 GB, you'll have plenty of room to safely store your favorite MP3s, movies, photos, and games.



### Features:

- Radical design – colorful, glows in the dark.
- Customizable – select fast or slow kaleidoscope mode and watch the lights morph across the color spectrum; save color settings, turn off the lights, or power off the drive with the touch of a button.
- Versatile – features both FireWire and USB 2.0 interface connections; works with both Windows and Macintosh systems.
- Instant storage – preformatted; simply plug it in and begin storing files.
- Fast – 7200 RPM and 8 MB cache performance for smooth digital video editing.



External Products	WD Dual-option Media Center	WD Dual-option Combo Drive	WD Dual-option USB Drive	WD Essential NetCenter Network Drive	WD Essential USB Drive	WD Extreme Lighted Combo Drive	WD Passport Portable Hard Drive
Capacities (GB)	320, 250, 200, 160, 120	320, 250, 200, 160, 120	320, 250, 200, 160, 120, 80	320, 250, 160	320, 250, 200, 160, 120, 80	320, 250, 160	80, 60, 40
Spin speed (RPM)	7200	7200	7200	7200	7200	7200	5400
Cache (MB)	8	8 (320, 250, 200, 160, 120 GB) 2 (120 GB)	8 (320, 250, 200 GB) 2 (160, 120, 80 GB)	8	8 (320 GB) 2 (250, 200, 160, 120, 80)	8	2
FireWire interface	•	•				•	
USB 2.0 interface	•	•	•		•	•	•
10/100Base-T Ethernet interface				•			
Clear light-up case						•	
Customizable lights						•	
Portable					•		•
Stands and feet	•	•	•	Stands	•		
Cool-running case	•	•	•	•	•		•
Kensington® security slot	•	•	•	•	•		
Power button on front	•	•	•	•	•		
Safe Shutdown	•	•	•				
Dual-option backup with software	•	•	•				
USB 2.0 hub with connector on front	•	•	•				
Integrated memory card reader	8-in-1						

# Accessories

## SATA RAID Controller

Step up to the power of Serial ATA with WD's SATA RAID Controller. Connect one SATA hard drive or optimize your computer with two drives configured for data striping (RAID 0) or mirroring (RAID 1).

**RAID 0** – Allows two identical drives to read and write data in parallel, doubling the sustained data transfer rate of SATA drives.

**RAID 1** – Offers fault-tolerant data redundancy (mirroring) for users who want to protect valuable data continually on their PCs.

### Features:

- Guaranteed compatibility with all SATA hard drives.
- Includes user-friendly software for easy RAID setup and management.
- Supports drive capacities exceeding 137 GB.
- Can be used on both 33 MHz and 66 MHz PCI bus motherboards.



Model WDAD010-RNx

# Awards

